



# DIN 11851 STAINLESS STEEL FITTINGS

DIN fittings (Deutsches Institut für Normung) are used in many hygienic industries and are available in metric and imperial sizes. The seals are available in two forms, the flanged or lipped design which provides a flush fitting and crevice free joint, or the more commonly used unlippled seal.

- Associated Standards: DIN 11851, DIN 11850, DIN 11864 and DIN 11887
- Material traceability to BS EN 10204

**We specialise in customised fabrication providing engineering solutions to customer specification**

**Dimensions provided are suitable for imperial tube. We also stock sizes for metric tube from 10mm to 150mm.**

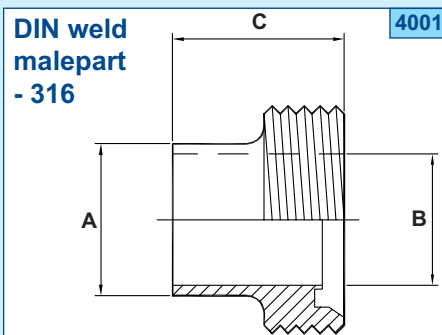

Nom Size	A	B	C
1"	25.4	22.1	29.0
1 1/2"	38.1	34.8	33.0
2"	50.8	47.5	35.0
2 1/2"	63.5	60.2	40.0
3"	76.2	72.9	45.0
4"	101.6	97.4	54.0

Standard Finish: 0.8Ra ID

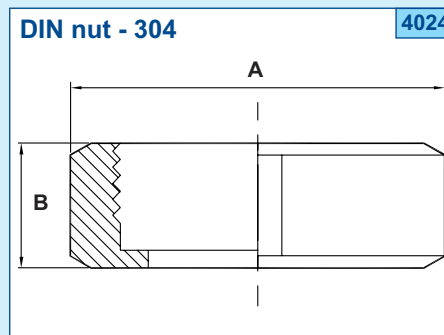

Nom Size	A	B
1"	63.0	21.0
1 1/2"	78.0	21.0
2"	92.0	22.0
2 1/2"	112.0	25.0
3"	127.0	29.0
4"	148.0	31.0

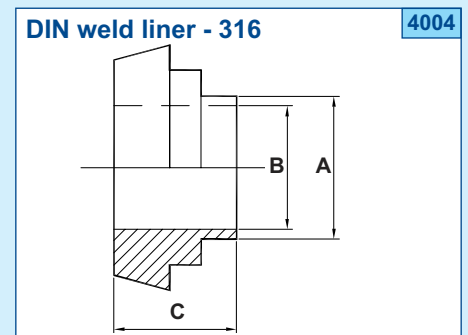

Nom Size	A	B	C
1"	25.4	22.1	22.0
1 1/2"	38.1	34.8	26.0
2"	50.8	47.5	28.0
2 1/2"	63.5	60.2	32.0
3"	76.2	72.9	37.0
4"	101.6	97.4	44.0

Standard Finish: 0.8Ra ID

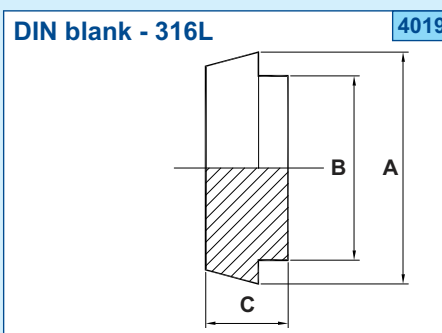

Nom Size	A	B	C
1"	44.0	35.0	13.0
1 1/2"	56.0	48.0	13.0
2"	68.0	61.0	14.0
2 1/2"	86.0	79.0	16.0
3"	100.0	93.0	16.0
4"	121.0	114.0	20.0

Standard Finish: 0.8Ra ID

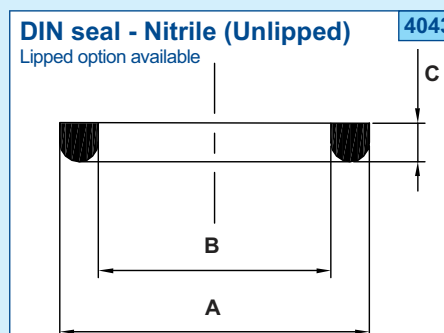

Nom Size	A	B	C
1"	40.0	30.0	5.0
1 1/2"	52.0	42.0	5.0
2"	64.0	54.0	5.0
2 1/2"	81.0	71.0	5.0
3"	95.0	85.0	5.0
4"	114.0	104.0	6.0

EPDM, Silicone, \*Viton® and PTFE options available



- Designed to operate up to 10 bar
- 316 stainless steel contact parts as standard, 304 option available

**DIN bends, tees, concentric and eccentric reducers can be fabricated in-house to customer specification**

(\*Viton® is a registered trademark of DuPont Dow Elastomers)