

Plain-ended eccentric reducers -316L

| Nom size fitting | | A | B | C | Max Op Pressure (bar) @ 20°C | Stock No |
|------------------|---------|-------|------|-------|---------------------------------|---------------|
| Larger | Smaller | | | | | |
| 1" | 1/2" | 25.4 | 12.7 | 25.0 | 10 | 8085-6026-013 |
| 1" | 3/4" | 25.4 | 19.1 | 19.0 | 10 | 8085-6026-019 |
| 1 1/2" | 1" | 38.1 | 25.4 | 34.0 | 10 | 8085-6038-026 |
| 2" | 1" | 50.8 | 25.4 | 49.0 | 10 | 8085-6051-026 |
| 2" | 1 1/2" | 50.8 | 38.1 | 37.0 | 10 | 8085-6051-038 |
| 2 1/2" | 1" | 63.5 | 25.4 | 68.0 | 10 | 8085-6064-026 |
| 2 1/2" | 1 1/2" | 63.5 | 38.1 | 74.0 | 10 | 8085-6064-038 |
| 2 1/2" | 2" | 63.5 | 50.8 | 45.0 | 10 | 8085-6064-051 |
| 3" | 1" | 76.2 | 25.4 | 101.0 | 10 | 8085-6076-026 |
| 3" | 1 1/2" | 76.2 | 38.1 | 80.0 | 10 | 8085-6076-038 |
| 3" | 2" | 76.2 | 50.8 | 65.0 | 10 | 8085-6076-051 |
| 3" | 2 1/2" | 76.2 | 63.5 | 32.0 | 10 | 8085-6076-064 |
| 4" | 1 1/2" | 101.6 | 38.1 | 125.0 | 10 | 8085-6102-038 |
| 4" | 2" | 101.6 | 50.8 | 96.0 | 10 | 8085-6102-051 |
| 4" | 2 1/2" | 101.6 | 63.5 | 110.0 | 10 | 8085-6102-064 |
| 4" | 3" | 101.6 | 76.2 | 70.0 | 10 | 8085-6102-076 |

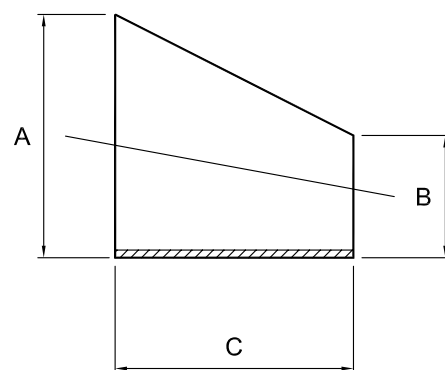

Technical Data:

- Material: 316L Stainless Steel
- Finish: 0.8RA or better
- Pressure: See above
- Associated standards: BS 4825 : Part 2 : 1991, ASTM A269, ASTM A270, ASTM A312
- Tolerance: +/- 0.5mm

- We stock a comprehensive range of plain-ended fittings including bends, tees, Y" pieces, hosetails and equal cross pieces
- Components can be fabricated to customer specification
- Fabrication capabilities include frameworks, skid mounted systems, manifolds, jacketed assemblies, adaptors, flowplates and spool pieces.
- In-house services include machining, welding, fabrication, polishing.

D8085-V02/ECN231

NOTES

- Dimensions are provided in good faith but maybe subject to change
- Seals must be chosen for required operating medium & temperature