

Clamp bend 45 deg 316L BS4825*

Nom size	L1	L2	R	Max Recommended Op Pressure (bar) @ 150°C	Stock No
1/2"	47.0	113.5	38.1	10	5074-6013
3/4"	54.0	130.5	38.1	10	5074-6019
*1"	36.5	88.2	38.1	10	5074-6026
*1½"	43.7	105.5	57.2	10	5074-6038
*2"	56.0	135.2	76.2	10	5074-6051
*2½"	69.0	166.7	95.3	10	5074-6064
*3"	81.4	196.6	114.3	10	5074-6076
*4"	101.6	245.3	152.4	10	5074-6102

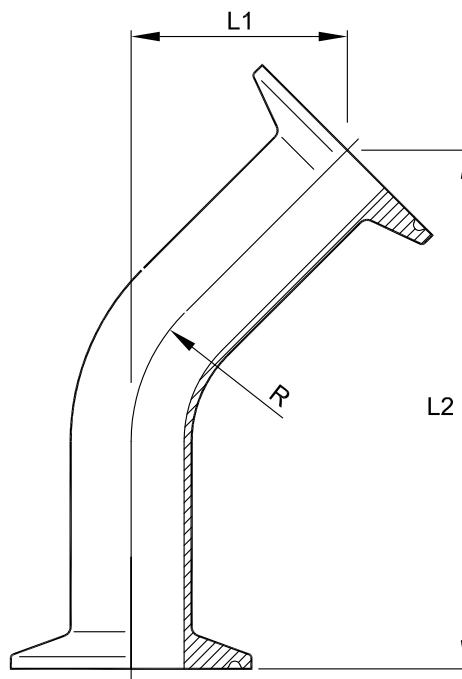

Technical Data:

- Material: 316L Stainless Steel
- Finish: Descaled ID, Polished 0.8Ra OD (0.4Ra available)
- Pressure/Temperature: See above (temp according to seal material)
- Associated standards: BS 4825 : Part 3 : 1991 (1" to 4" inclusive)
- Applications : Clamp fittings are suitable for beverage, fine chemical, pharmaceutical and biotech applications, where crevice free conditions are critical.
- Tolerance: +/- 0.5mm
- Seals: EPDM, Nitrile, Silicone, Platinum Cured Silicone, Encapsulated & Solid PTFE, Viton®
Viton® is a registered trademark of DuPont Dow Elastomers

- We stock a comprehensive range of clamp fittings including unions, ferrules, bends, tees, reducers, hoseliners and adaptors
- Components can be fabricated to customer specification
- Fabrication capabilities include frameworks, skid mounted systems, manifolds, jacketed assemblies, adaptors, flowplates and spool pieces.
- In-house services include machining, welding, fabrication, polishing.

D5074- V03/ECN155

NOTES

- Dimensions are provided in good faith but maybe subject to change
- Seals must be chosen for required operating medium & temperature

(T) +44 (0)1792 883 882
 (F) +44 (0)1792 886 049
 (E) info@axiumprocess.com
 (W) www.axiumprocess.com